

CLIPSAL[®]

LIVING ELECTRICAL

3 Speed Fan Controller

Installation Instructions

30CSFM Series

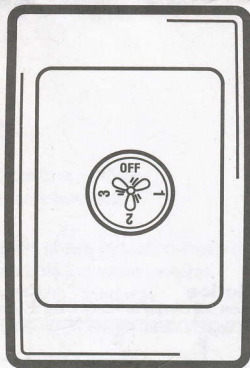

REGISTERED DESIGN



Table of Contents

Section.....	Page
1.0 Product Range	3
2.0 Description	3
3.0 Features	3
4.0 Load Compatibility.....	4
5.0 Important Warning.....	4
6.0 Installation Instructions	5
7.0 Compatible Airflow Ceiling Sweep Fans	6
8.0 Fan Installation Checklist	6
9.0 Also Available from Clipsal	6
10.0 Electrical Specifications	7

Copyright Notice

The concepts, products and designs described in this document are subject of international patents, and protected by international law. © Copyright Clipsal Australia Pty Ltd All rights reserved.

Trademarks

- Clipsal is a registered trademark of Clipsal Australia Pty Ltd.
 - C-Thru - The Clear Choice is a registered trademark of Clipsal Australia Pty Ltd.
- All other logos and trademarks are property of their respective owners.

Disclaimer

Clipsal Australia Pty Ltd reserves the right to change specifications or designs described in this manual without notice and without obligation.

1.0 Product Range

30CSFM	Fan Speed Controller, 220-240Va.c., 50Hz, 75VA (30 Series Mechanism)
31VF3CSF	Fan Speed Controller, 220-240Va.c., 50Hz, 75VA (Standard Range)
2031VF3CSF	Fan Speed Controller, 220-240Va.c., 50Hz, 75VA (2000 Series)
C2031VF3CSF	Fan Speed Controller, 220-240Va.c., 50Hz, 75VA (Classic Series)

* Please note that these products are also available in other configurations and in a wide range of colours. For further information, please contact your nearest Clipsal Sales Representative.

2.0 Description

The Clipsal 30CSFM Series 3 Speed Fan Controller is designed to provide discrete, linear speed control over small motor loads, including Clipsal's extensive range of Airflow Ceiling Sweep Fans.

The Fan Controller unit incorporates a 3 position rotary switch mechanism and a multi-tap capacitor block. This method of control overcomes the motor 'growl' (or buzzing noises) often emitted from fans controlled by other electronic (phase control) speed setters and ensures quiet operation of the fan motor.

The 30CSFM Series Fan Controller is suitable for use in any new installation, but is also retro-fittable, and may be used to replace an existing controller standard switch in any existing installation. This includes many older style 'choke controllers'.

3.0 Features

- 3 Speed Rotary Switch Controller
- Multi-tap Capacitive Attenuation Block
- Three Linear Speed Settings (Lo, Med, Hi)
- 75VA Rating
- Wall or architrave mounting options, horizontal or vertical
- Wide range of plate styles and colour variants available
- Suitable for 1-way or 2-way operation
- Suitable for use with ceiling sweep fans (split phase induction motors)
- Suitable for use with exhaust fans (shaded pole induction motors)
- Complies with Australian and International EMC Standards.

SWITCH POSITION	1	2	3
SPEED SETTING	Lo	Med	Hi
CAPACITANCE VALUE	1.3uF	2.2uF	0
APPROXIMATE SPEED*	100 rpm	200 rpm	275 rpm

* Actual speed may vary slightly with respect to the specific model fan selected for the installations



30CSFM
FAN MECHANISM



2031VF3CSF
2000 SERIES PLATE

4.0 Load Compatibility

Controlling a Single Fan

The 30CSFM Series 3 Speed Fan Controller may be used to operate a single Airflow Ceiling Sweep Fan.

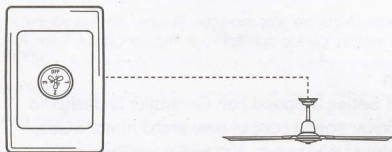

Multiple Fans on a Single Controller

Where multiple fans are required to be operated from a single speed controller, a Clipsal C-Thru® Electronic Fan Speed Controller (sold separately) must be used.

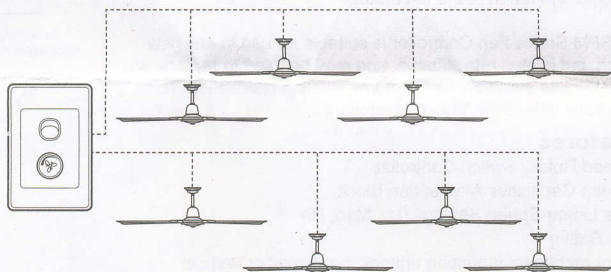

You can control up to 8 Airflow Ceiling Sweep Fans using a Clipsal C-Thru® Electronic Fan Speed Controller (catalogue number 32E500FM).

Note:

The 30CSFM 3 Speed Fan Controller supplied with each fan is not suitable for controlling multiple fans. Failure to comply with this instruction will void any warranty associated with the product.

5.0 Important Warning

It is illegal for persons other than an appropriately licenced electrical contractor or other persons authorised by legislation to work on the fixed wiring of any electrical installation. Penalties for conviction are severe!

6.0 Installation Instructions

Connecting the Speed Controller

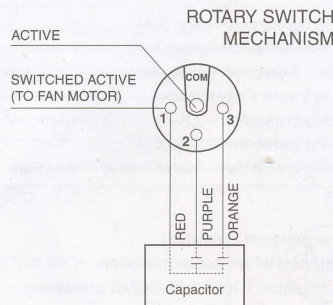

Fan Only

1. Remove the Switch Surround
2. Terminate cables as shown. Connect:
 - Active feed to Common Terminal
 - Switched Active / Fan to Terminal 1
3. Fix Capacitor Block to Grid Plate
4. Fix Controller to Wallbox or Bracket
5. Replace Switch Surround
6. Apply power to circuit
7. Test fan operation.

Mounting Orientation

The arrangement of the controller as shipped suits vertical installation. To mount the controller in a horizontal position:

1. Lever the knob from the shaft.
2. Prise mech out of aperture and rotate 90°.
3. Clip mechanism into new position and replace knob.

Unit Operation

Turn the knob to Speed 3 (Hi). This will start the fan spinning. Once the fan is spinning then you can select a lower speed if desired.

Connecting the Speed Controller with a Light Switch

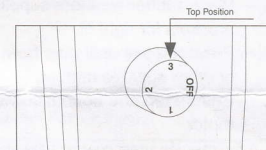
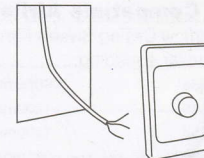
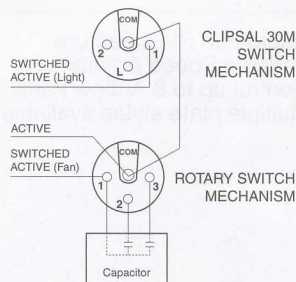

The speed setting should always be located at the TOP POSITION of the knob as illustrated

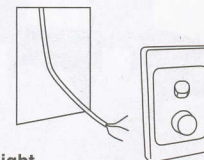

Fan with a Light

Requires additional components (supplied separately)

- 30M Switch Mechanism
 - Two Gang Grid Plate and Surround (eg 2000 Series – 2032VH)
- Connect as shown in the diagram.

7.0 Compatible Airflow Ceiling Sweep Fans

All Airflow Ceiling Sweep Fans are compatible with the 30CSFM Series 3 Speed Fan Controller, including:

ACES36	900mm (36") Reversible Ceiling Sweep Fan – Hang Sure
ACES48	1200mm (48") Reversible Ceiling Sweep Fan – Hang Sure
ACES56	1400mm (56") Reversible Ceiling Sweep Fan – Hang Sure
ACES36J	900mm (36") Reversible Ceiling Sweep Fan – J Hook
ACES48J	1200mm (48") Reversible Ceiling Sweep Fan – J Hook
ACES56J	1400mm (56") Reversible Ceiling Sweep Fan – J Hook
AFLR48	1200mm (48") Reversible Ceiling Sweep Fan – Rattan Blades – Hang Sure

8.0 Fan Installation Checklist

The following guidelines should be followed to ensure quiet operation:

1. Ensure all bolts and screws are properly tightened when assembling fan.
2. Check fit of support hook to rubber support insulator. If loose, fit rubber sheathing provided to ensure neat fit.
3. Place rubber washers supplied between support insulator and support insulator brackets for tight fit.
4. Prevent loose split pins from rattling by covering with small piece of insulation tape or other suitable method.
5. Ensure top and bottom cowls are securely fixed and slightly clear of ceiling and fan motor.

* A few minutes spent checking the above will, in most cases ensure silent operation of the fan.

9.0 Also Available from Clipsal



C-Thru® Electronic Fan Controllers

- Rapid Fan Start Feature
- Variable Speed Adjustment
- Control up to 8 Airflow Fans
- Multiple plate styles available



10.0 Electrical Specifications

Parameter	Value	
Nominal Operating Voltage	220 - 240V a.c.	
Nominal Operating Frequency	50 Hz	
Maximum Load	75VA (Limit ONE ONLY Ceiling Sweep Fan per Controller)	
Speed Control Technique	Capacitive Attenuation	
Compatible Loads		Ceiling fans (split-phase induction motors) Exhaust fans (shaded pole induction motors)
Operating Temperature Range	0 to 40°C	
Operating Humidity Range	10 to 90% R.H.	
Mounting Centres	84mm	Australian Pattern Plate
Shipping Weight	25g	Fan Control Mechanism Only
EMC Emission Compliance	AS/NZS CISPR 15:2002	
Specifications Typical @ 25°C ± 5°C		
No User Serviceable Parts Inside		